

2023

Wendeplattenbohrer 3xD - 8xD und 10xD GTRD - DHTR - DHMTR



GTR3D - 3xD



DHTR - 8xD



DHMTR - 10xD

DIN 9766

Wendeplattenbohrer

Indexable Drills

Record INDEX Drill

Bohrkörper / Drills Bodies

(Ø 16,00 - Ø 50,00)

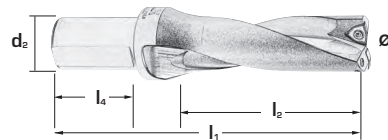

NEW



Ø mm	l ₁ mm	l ₂ mm	l ₄ mm	d ₂ mm	Schraube	Wendeplatte	Schraube für	Schlüssel	GTR3D
					Screw	Insert	Wendeplatte	Screw driver	
					GA	LC-MC	VT	KY	
16,0	128	51	50	20	GA 1/8	WCEX 030204..	VT 2.2X0.45	KY T6	●
16,5	130	53	50	20	GA 1/8	WCEX 030204..	VT 2.2X0.45	KY T6	●
17,0	131	54	50	20	GA 1/8	WCEX 030204..	VT 2.2X0.45	KY T6	●
17,5	133	56	50	20	GA 1/8	WCEX 030204..	VT 2.2X0.45	KY T6	●
18,0	134	57	50	20	GA 1/8	WCEX 030204..	VT 2.2X0.45	KY T6	●
18,5	136	59	50	20	GA 1/8	WCEX 030204..	VT 2.2X0.45	KY T6	●
19,0	137	60	50	20	GA 1/8	WCEX 030204..	VT 2.2X0.45	KY T6	●
19,5	139	62	50	20	GA 1/8	WCEX 030204..	VT 2.2X0.45	KY T6	●
20,0	140	63	50	20	GA 1/8	WCEX 030204..	VT 2.2X0.45	KY T6	●
20,5	151	65	60	25	GA 1/8	WCEX 040204..	VT 2.5X0.45	KY T8	●
21,0	152	66	60	25	GA 1/8	WCEX 040204..	VT 2.5X0.45	KY T8	●
21,5	154	68	60	25	GA 1/8	WCEX 040204..	VT 2.5X0.45	KY T8	●
22,0	155	69	60	25	GA 1/8	WCEX 040204..	VT 2.5X0.45	KY T8	●
22,5	157	71	60	25	GA 1/8	WCEX 040204..	VT 2.5X0.45	KY T8	●
23,0	158	72	60	25	GA 1/8	WCEX 040204..	VT 2.5X0.45	KY T8	●
23,5	160	74	60	25	GA 1/8	WCEX 040204..	VT 2.5X0.45	KY T8	●
24,0	161	75	60	25	GA 1/8	WCEX 040204..	VT 2.5X0.45	KY T8	●
24,5	163	77	60	25	GA 1/8	WCEX 040204..	VT 2.5X0.45	KY T8	●
25,0	164	78	60	25	GA 1/8	WCEX 040204..	VT 2.5X0.45	KY T8	●
25,5	175	80	60	25	GA 1/8	WCEX 040204..	VT 2.5X0.45	KY T8	●
26,0	176	81	70	32	GA 1/4	WCEX 050308..	VT 3X0.5	KY T8	●
26,5	178	83	70	32	GA 1/4	WCEX 050308..	VT 3X0.5	KY T8	●
27,0	179	84	70	32	GA 1/4	WCEX 050308..	VT 3X0.5	KY T8	●
27,5	181	86	70	32	GA 1/4	WCEX 050308..	VT 3X0.5	KY T8	●
28,0	182	87	70	32	GA 1/4	WCEX 050308..	VT 3X0.5	KY T8	●
28,5	184	89	70	32	GA 1/4	WCEX 050308..	VT 3X0.5	KY T8	●
29,0	185	90	70	32	GA 1/4	WCEX 050308..	VT 3X0.5	KY T8	●
29,5	187	92	70	32	GA 1/4	WCEX 050308..	VT 3X0.5	KY T8	●
30,0	188	93	70	32	GA 1/4	WCEX 050308..	VT 3X0.5	KY T8	●
31,0	191	96	70	32	GA 1/4	WCEX 06T308..	VT 3.5X0.6	KY T15	●
32,0	194	99	70	32	GA 1/4	WCEX 06T308..	VT 3.5X0.6	KY T15	●
33,0	197	102	70	32	GA 1/4	WCEX 06T308..	VT 3.5X0.6	KY T15	●
34,0	200	105	70	32	GA 1/4	WCEX 06T308..	VT 3.5X0.6	KY T15	●
35,0	203	108	70	32	GA 1/4	WCEX 06T308..	VT 3.5X0.6	KY T15	●
36,0	206	111	70	32	GA 1/4	WCEX 06T308..	VT 3.5X0.6	KY T15	●
37,0	209	114	70	32	GA 1/4	WCEX 06T308..	VT 3.5X0.6	KY T15	●
38,0	212	117	70	32	GA 1/4	WCEX 06T308..	VT 3.5X0.6	KY T15	●
39,0	215	120	70	32	GA 1/4	WCEX 06T308..	VT 3.5X0.6	KY T15	●
40,0	218	123	70	32	GA 1/4	WCEX 06T308..	VT 3.5X0.6	KY T15	●
41,0	221	126	70	32	GA 1/4	WCEX 06T308..	VT 3.5X0.6	KY T15	●
42,0	239	129	80	40	GA 1/4	WCEX 080408..	VT 4X0.7	KY T15	●
43,0	242	132	80	40	GA 1/4	WCEX 080408..	VT 4X0.7	KY T15	●
44,0	245	135	80	40	GA 1/4	WCEX 080408..	VT 4X0.7	KY T15	●
45,0	248	138	80	40	GA 1/4	WCEX 080408..	VT 4X0.7	KY T15	●

● Standardartikel / Items available ex stock

DIN 9766

Pilotbohrer für Wendepplattenbohrer

Indexable drills with pilot drill

Record INDEX Drill mit Pilotbohrer/with pilot drill

Bohrkörper / Drills Bodies

(Ø 25,00 - Ø 45,00)



NEW



Ø mm	l ₁ mm	l ₂ mm	l ₄ mm	d ₂ mm	Schraube Screw	Wendepplatte Insert	Schraube für Wendepplatte Screw insert	Schlüssel Screw driver	Pilotbohrer Pilot Drill	DHTR
					GA	LC-MC	VT	KY	DHP	
25	315	220	60	32	GA 1/4	WCEX 030204..	VT 2.2X0.45	KY T6	DHP 6X30	●
26	315	220	60	32	GA 1/4	WCEX 040204..	VT 2.5X0.45	KY T8	DHP 6X30	●
27	315	220	60	32	GA 1/4	WCEX 040204..	VT 2.5X0.45	KY T8	DHP 6X30	●
28	315	220	60	32	GA 1/4	WCEX 040204..	VT 2.5X0.45	KY T8	DHP 6X30	●
29	315	220	60	32	GA 1/4	WCEX 040204..	VT 2.5X0.45	KY T8	DHP 6X30	●
30	315	220	60	32	GA 1/4	WCEX 040204..	VT 2.5X0.45	KY T8	DHP 6X30	●
31	355	260	60	32	GA 1/4	WCEX 050308..	VT 3X0.5	KY T8	DHP 8X35	●
32	355	260	60	32	GA 1/4	WCEX 050308..	VT 3X0.5	KY T8	DHP 8X35	●
33	355	260	60	32	GA 1/4	WCEX 050308..	VT 3X0.5	KY T8	DHP 8X35	●
34	355	260	60	32	GA 1/4	WCEX 050308..	VT 3X0.5	KY T8	DHP 8X35	●
35	355	260	60	32	GA 1/4	WCEX 050308..	VT 3X0.5	KY T8	DHP 8X35	●
36	355	300	60	32	GA 1/4	WCEX 050308..	VT 3X0.5	KY T8	DHP 8X35	●
37	395	300	60	32	GA 1/4	WCEX 050308..	VT 3X0.5	KY T8	DHP 8X35	●
38	395	300	60	32	GA 1/4	WCEX 050308..	VT 3X0.5	KY T8	DHP 8X35	●
39	395	300	60	32	GA 1/4	WCEX 050308..	VT 3X0.5	KY T8	DHP 8X35	●
40	395	300	70	32	GA 1/4	WCEX 050308..	VT 3X0.5	KY T8	DHP 8X35	●
*41	460	340	80	40	GA 1/4	WCEX 06T308..	VT 3.5X0.6	KY T15	DHP 10X35	●
*42	460	340	80	40	GA 1/4	WCEX 06T308..	VT 3.5X0.6	KY T15	DHP 10X35	●
*43	460	340	80	40	GA 1/4	WCEX 06T308..	VT 3.5X0.6	KY T15	DHP 10X35	●
*44	460	340	80	40	GA 1/4	WCEX 06T308..	VT 3.5X0.6	KY T15	DHP 10X35	●
*45	460	340	80	40	GA 1/4	WCEX 06T308..	VT 3.5X0.6	KY T15	DHP 10X35	●

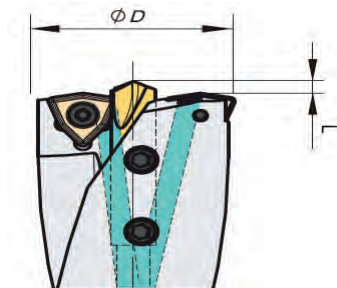

Ø D	L mm
18-24	2.5
25-30	3.0
31-39	4.0
40-45	4.5

Ersatzteile/ Spare parts (siehe Seite 136 / see page 136)



DHMTR

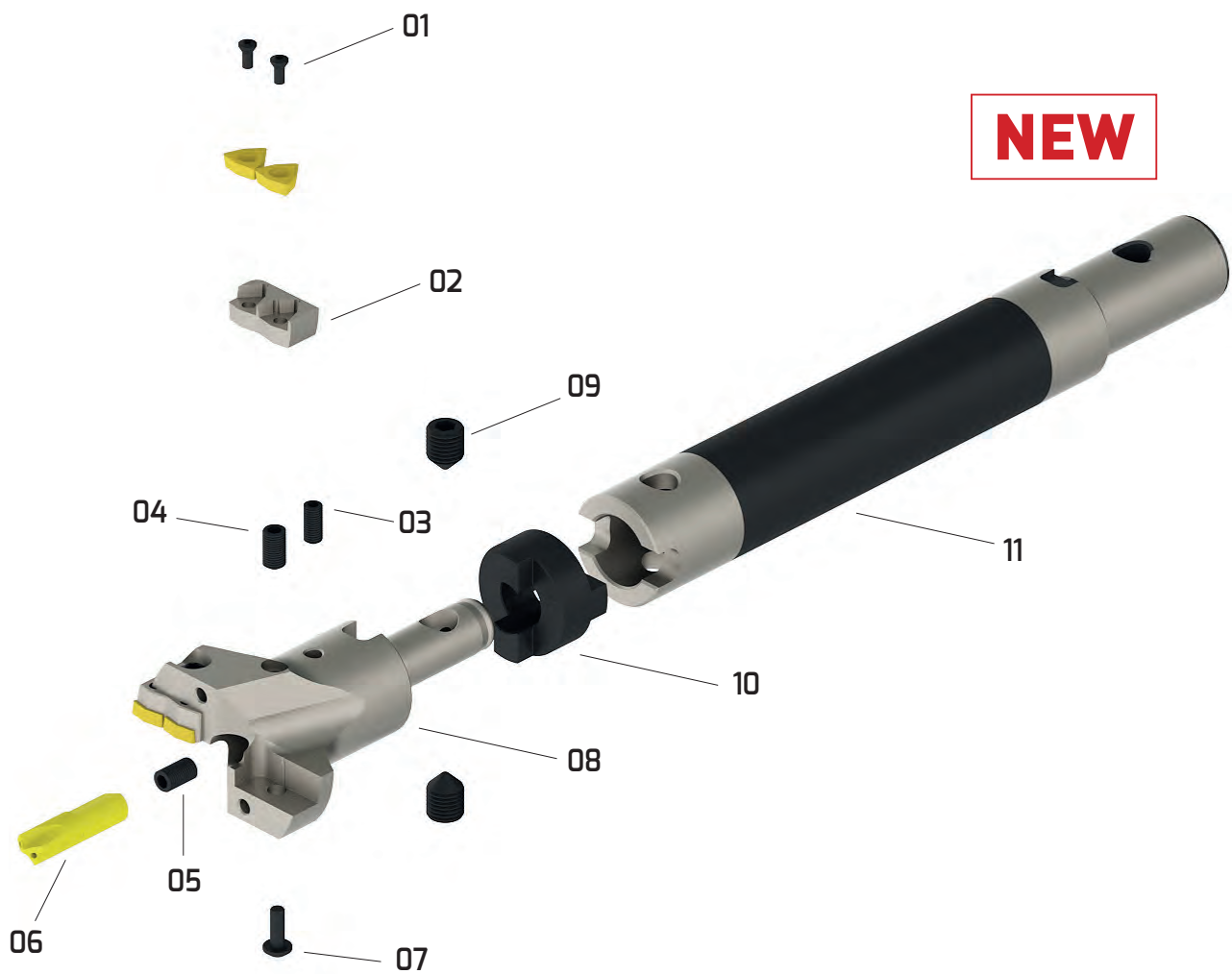

- WENDEPLATTEN-SCHRAUBE - Insert screw ■ 01
- PARTRONE INNEN / AUSSEN - Cartridge Inner/Outer ■ 02
- BEFESTIGUNGSSCHRAUBE FÜR PILOTBOHRER - Fixing Screw for Pilot Drill ■ 03
- KLEMMBOLZEN FÜR PILOTBOHRER - Clamping Bolt for Pilot Drill ■ 04
- JUSTIERSCHRAUBE FÜR PILOTBOHRER - Adjustment Screw for Pilot Drill ■ 05
- PILOTBOHRER - Pilot Drill ■ 06
- BEFESTIGUNGSSCHRAUBE FÜR EINBAUKASSETTE - Screw for Cartridge ■ 07
- HALTER DHMTR - Drill Body DHMTR ■ 08
- BEFESTIGUNGSSCHRAUBE - Fixation Screw ■ 09
- ANTRIEBSRING - Drive Ring ■ 10
- DHMSH SCHAFT UND DHMEX VERLÄNGERUNG - DHMSH Shank and DHMEX Extension ■ 11

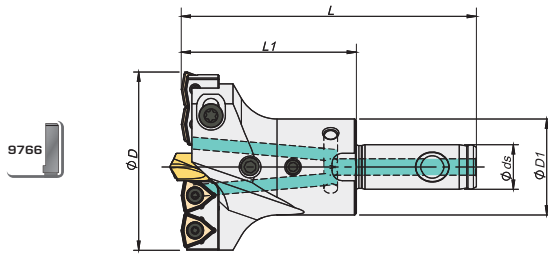

DHMTR Bohrer / Drill

(Ø 45,00 - Ø 130,00)

NEW

Ø D mm min-max	Ø D1 mm	Ø ds mm	L1 mm	L mm	Innen Patrone Internal Cartridge	Außen Patrone External Cartridge	Wendeplatte insert	Pilotbohrer Pilot Drill DHP	DHMTR
45-50	28	13	50	85	CI 45-50	CE 45-50	WCEX 030204..	DHP 10X35	●
50-55	28	13	50	85	CI 50-55	CE 50-55	WCEX 030204..	DHP 10X35	●
55-60	32	16	60	100	CI 55-60	CE 55-60	WCEX 040204..	DHP 12X38	●
60-65	32	16	60	100	CI 60-65	CE 60-65	WCEX 050308..	DHP 12X38	●
65-70	32	16	60	100	CI 65-70	CE 65-70	WCEX 050308..	DHP 12X38	●
70-75	40	22	70	115	CI 70-75	CE 70-75	WCEX 050308..	DHP 12X38	●
75-80	40	22	70	115	CI 75-80	CE 75-80	WCEX 06T308..	DHP 16X45	●
80-85	40	22	70	115	CI 80-85	CE 80-85	WCEX 06T308..	DHP 16X45	●
85-90	48	27	70	120	CI 85-90	CE 85-90	WCEX 06T308..	DHP 16X45	●
90-95	48	27	70	120	CI 90-95	CE 90-95	WCEX 06T308..	DHP 16X45	●
95-100	48	27	70	120	CI 95-100	CE 95-100	WCEX 06T308..	DHP 16X45	●
100-105	58	32	80	130	CI 100-105	CE 100-105	WCEX 050308..	DHP 20X45	●
105-110	58	32	80	130	CI 105-110	CE 105-110	WCEX 06T308..	DHP 20X45	●
110-115	58	32	80	130	CI 110-115	CE 110-115	WCEX 06T308..	DHP 20X45	●
115-120	70	40	90	145	CI 115-120	CE 115-120	WCEX 06T308..	DHP 20X45	●
120-125	70	40	90	145	CI 120-125	CE 120-125	WCEX 06T308..	DHP 25X56	●
125-130	70	40	90	145	CI 125-130	CE 125-130	WCEX 06T308..	DHP 25X56	●

Pilotbohrer separat bestellt werden / Pilot drill to be ordered separately (siehe Seite 134 / see page 134)
 Patronen inbegriffen / Cartridges included (siehe Seite 135 / see page 135)

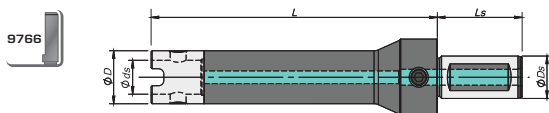

NEW



Schaft Basis / Shank

Abmessung mm Measure mm	Ø ds mm	Ø Ds mm	Ø D mm	L mm	Ls mm	Antriebsring Drive ring	DHMSH
13x115	13	32	28	115	70	DHRG 28	●
13x200	13	32	28	200	70	DHRG 28	●
13x300	13	32	28	300	70	DHRG 28	●
16x125	16	40	32	125	82	DHRG 32	●
16x200	16	40	32	200	82	DHRG 32	●
16x300	16	40	32	300	82	DHRG 32	●
22x148	22	40	40	148	82	DHRG 40	●
22x200	22	40	40	200	82	DHRG 40	●
22x300	22	40	40	300	82	DHRG 40	●
27x168	27	40	48	168	82	DHRG 48	●
27x300	27	40	48	300	82	DHRG 48	●
32x186	32	40	58	186	82	DHRG 58	●
32x300	32	40	58	300	82	DHRG 58	●
40x186	40	50	70	186	82	DHRG 70	●
40x300	40	50	70	300	82	DHRG 70	●

● Standardartikel / Items available ex stock

Bereich von Einsätzen nach Auswahl der richtigen Sorte nach Materialgruppen.

Range of inserts and selection of the proper grade according to the material groups.

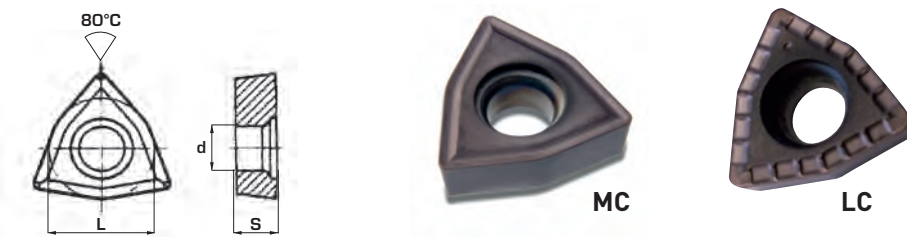

NEW

Wendepplatten Schlüssel Insert code ISO	Geeignete Qualität Suitable quality		Größe Dimensions		
	AGP 25	AGP 35	d	s	L
WCEX 030204-MC	●	●	2,50	2,43	5,56
WCEX 040204-MC	●	●	2,80	2,38	6,35
WCEX 050308-MC	●	●	3,37	3,25	7,94
WCEX 06T308-MC	●	●	4,40	4,04	9,52
WCEX 080408-MC	●	●	5,51	4,04	12,72
WCEX 050308-LC	●	●	3,37	3,25	7,94
WCEX 06T308-LC	●	●	4,40	4,04	9,52

NEW

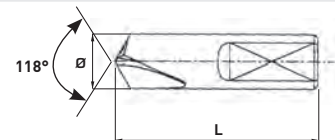

Pilotbohrer Pilot drill DHP	Abmessung Dimensions Ø L	Qualität - Quality HSS-Co	Beschichtung - Coating TiN	Für Bohrer For Drills
DHP	6X30	●	●	DHTR
DHP	8X35	●	●	DHTR
DHP	10X35	●	●	DHTR - DHMTR
DHP	12X38	●	●	DHMTR
DHP	16x45	●	●	DHMTR
DHP	20x45	●	●	DHMTR
DHP	25x56	●	●	DHMTR

Schrauben für die axiale Verstellung des Pilotbohrer

Screw for pilot's axial adjust



Kat.-Nr. Cat. No	Abmessung Dimensions
GAR	M5X0.8
GAR	M6X1.0
GAR	M8X1.2

Schrauben für die Befestigung Pilotbohrer

Screw for pilot's axial adjust



Kat.-Nr. Cat. No	Abmessung Dimensions
GAF	M5X0.8
GAF	M6X1.0
GAF	M6X1.2
GAF	M8X1.2

NEW



Patrone für DHTR / Cartridges for DHTR

Ø D mm	Innen Patrone Internal Cartridge	Außen Patrone External Cartridge	Patronen Schraube Cartridge scew	Einsatz insert	Schraube für Einsatz Screw insert	CI-CE
41	CI 4145	CE 4141	VTS 5X10	WCEX 06T308..	VT 3.5X0.6	●
42	CI 4145	CE 4142	VTS 5X10	WCEX 06T308..	VT 3.5X0.6	●
43	CI 4145	CE 4143	VTS 5X10	WCEX 06T308..	VT 3.5X0.6	●
44	CI 4145	CE 4144	VTS 5X10	WCEX 06T308..	VT 3.5X0.6	●
45	CI 4145	CE 4145	VTS 5X10	WCEX 06T308..	VT 3.5X0.6	●

NEW



Patrone für DHMTR / Cartridges for DHMTR

Ø D mm min-max	Innen Patrone Internal Cartridge	Außen Patrone External Cartridge	(07) Patronen Schraube Cartridge scew	Einsatz insert	Schraube für Einsatz Screw insert	CI-CE
45-50	CI 4550	CE 4550	VTSM 4X10	WCEX 030204..	VT 2.2X0.45	●
50-55	CI 5055	CE 5055	VTSM 4X10	WCEX 030204..	VT 2.2X0.45	●
55-60	CI 5560	CE 5560	VTSM 5X12	WCEX 040204..	VT 2.5X0.45	●
60-65	CI 6065	CE 6065	VTSM 5X12	WCEX 050308..	VT 3X0.5	●
65-70	CI 6570	CE 6570	VTSM 5X12	WCEX 050308..	VT 3X0.5	●
70-75	CI 7075	CE 7075	VTSM 5X12	WCEX 050308..	VT 3X0.5	●
75-80	CI 7580	CE 7580	VTSM 6X12	WCEX 06T308..	VT 3.5X0.6	●
80-85	CI 8085	CE 8085	VTSM 6X14	WCEX 06T308..	VT 3.5X0.6	●
85-90	CI 8590	CE 8590	VTSM 6X16	WCEX 06T308..	VT 3.5X0.6	●
90-95	CI 9095	CE 9095	VTSM 6X16	WCEX 06T308..	VT 3.5X0.6	●
95-100	CI 9510	CE 9510	VTSM 6X16	WCEX 06T308..	VT 3.5X0.6	●
100-105	CI 1105	CE 1105	VTSM 8X18	WCEX 050308..	VT 3X0.5	●
105-110	CI 1511	CE 1511	VTSM 8X18	WCEX 06T308..	VT 3.5X0.6	●
110-115	CI 1115	CE 1115	VTSM 8X18	WCEX 06T308..	VT 3.5X0.6	●
115-120	CI 1512	CE 1512	VTSM 8X20	WCEX 06T308..	VT 3.5X0.6	●
120-125	CI 1225	CE 1225	VTSM 8X25	WCEX 06T308..	VT 3.5X0.6	●
125-130	CI 1253	CE 1253	VTSM 8X25	WCEX 06T308..	VT 3.5X0.6	●

BOHRERDURCHMESSER ÄNDERUNG DURCH ÄUSSERE PATRONE EINSTELLUNG.

Drill diameter change by outer cartridge adjustment.

Einstellbare Außen Patronen durch Entfernen radialen Material kleinere Durchmesser angepasst.

Verkürzen bei 90 ° zur Flächenkontakt A und B

Adjustable outer cartridges adapted to minor diameter by removing radial material.

Shorten at 90° to the Face contact A and B

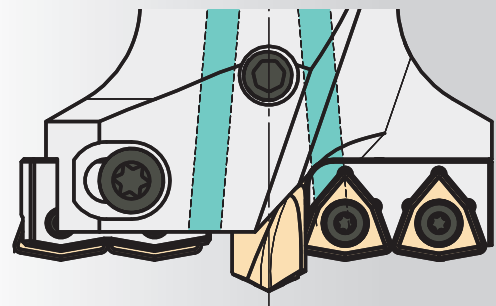
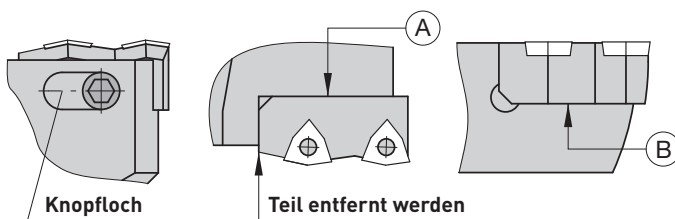

Ersatzteile / Spare Parts

NEW

DHMTR Bohrer / Drill:

Ø D mm min-max	(03) Befestigungsschraube für Pilotbohrer Fixing Screw for Pilot Drill	(04) Klemmbolzen für Pilotbohrer Clamping Bolt for Pilot Drill	(05) Justierschraube für Pilotbohrer Adjustment Screw for Pilot Drill	(09) Befestigungsschraube Fixation Screw
45-50	GASM 4X8	GAFM 6X10	GARM 6X10	GABM 8X12
50-55	GASM 4X8	GAFM 6X10	GARM 6X10	GABM 8X12
55-60	GASM 4X8	GAFM 8X12	GARM 8X15	GABM 8X12
60-65	GASM 5X8	GAFM 8X12	GARM 8X15	GABM 8X12
65-70	GASM 5X8	GAFM 8X12	GARM 8X15	GABM 8X12
70-75	GASM 5X8	GAFM 8X15	GARM 8X15	GABM 10X15
75-80	GASM 6X10	GAFM 10X20	GARM 10X16	GABM 10X15
80-85	GASM 6X10	GAFM 10X20	GARM 10X16	GABM 10X15
85-90	GASM 6X10	GAFM 10X20	GARM 10X18	GABM 12X18
90-95	GASM 6X10	GAFM 10X20	GARM 10X18	GABM 12X18
95-100	GASM 6X10	GAFM 10X20	GARM 10X18	GABM 12X18
100-105	GASM 6X10	GAFM 12X20	GARM 12X20	GABM 12X20
105-110	GASM 6X10	GAFM 12X20	GARM 12X20	GABM 12X20
110-115	GASM 6X10	GAFM 12X20	GARM 12X20	GABM 12X20
115-120	GASM 6X10	GAFM 12X25	GARM 14X20	GABM 16X27
120-125	GASM 6X10	GAFM 14X25	GARM 14X20	GABM 16X27
125-130	GASM 6X10	GAFM 14X25	GARM 14X20	GABM 16X27

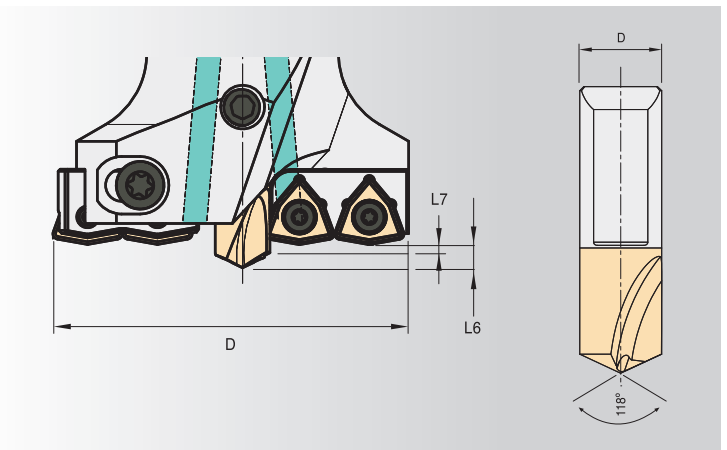
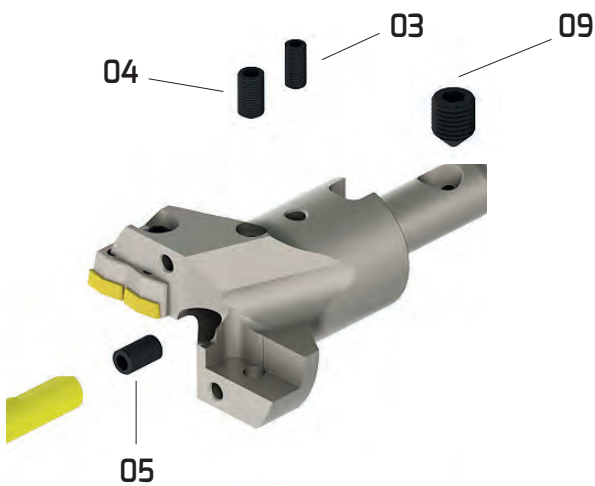

Überlanger Pilotbohrer / Overlong Pilot Drill:

DC (mm)	2D bis 4D 2D to 4D		4D bis 6D 4D to 6D		>6D	
	L7	L6	L7	L6	L7	L6
45-50	1.6	4.0	1.8	4.2	2.0	4.4
50-75	1.8	5.4	2.0	5.6	2.2	5.8
75-100	2.2	6.5	2.5	6.8	2.8	7.1
100-130	2.4	7.7	2.8	8.1	3.2	8.5

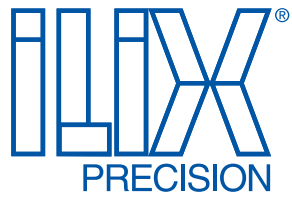

ILIX Präzisionswerkzeuge GmbH

Gutenbergstraße, 5
D - 65830 Kriftel
Tel. +49 (0) 6192 / 40 90 - 0
Fax +49 (0) 6192 / 40 90 60

info@ilix.com
www.ilix.com